



# CONNECT & EXCHANGE AT W AMSTERDAM. SET AT THE EPICENTER OF THE DUTCH CAPITAL, W AMSTERDAM IS JUST STEPS FROM THE CITY'S VIBRANT NIGHTLIFE, BARS, RESTAURANTS AND SHOPPING.

## THE EPICENTER OF AMSTERDAM

Mixing historical Dutch architectural elements with cutting-edge design right next to Dam Square, W Amsterdam is at the epicenter of this energetic and forward-thinking city. Marvel at dazzling views from our spot between the Royal Palace and the UNESCO-listed Singel canal.

## A FABULOUS RETREAT

Let the elevator take you up to our rooftop for a check-in experience unlike any other. Relax in one of our 238 guest rooms and suites - each is a fabulous retreat that mixes historical details with contemporary features. Recharge with our W signature bed and peek-a-boo shower, complemented by touches of local design. For the ultimate experience, check out one of our WOW or E-WOW Suites.

## MAGNIFY YOUR ESCAPE

Indulge in one of our destination restaurants The Duchess and MR PORTER and taste signature sips at our rooftop W Lounge overlooking the Royal Palace and the city lights. Get exclusive access to a vibrant nightlife, dining, shopping and fashion scene with our signature Whatever/Whenever® service, our in-the-know W Insider and our W Happenings.

## SPECTACULAR EVENTS

Leave mild-mannered meetings behind! Right here in our 414 square meters of event space, W Amsterdam features fully adaptable conference equipment that makes business beautiful, meetings memorable and special events spectacular. Endless possibilities, creative in approach and innovative in design, we'll engage and energize your attendees and participants, from conferences to soirées.

## STARWOOD PREFERRED GUEST® (SPG)

Access amplified. Join Starwood Preferred Guest for immediate access - and zero blackouts on Free Night Awards - to a vibrant mix of hotels and resorts all over the world. Plan your escape to any of our 1100+ properties spanning ten dynamic brands in 100 countries.

## SPG PRO

Reward yourself. Earn for work. Redeem for fun. Meeting planners and travel professionals can now earn Starpoints® and credit toward elite status for personal and professional bookings - all in one easy SPG® account.

## KEY FEATURES

- 300-meter walk to Dam Square
- Split across two monumental buildings
- 238 Rooms & Suites
- 2 Destination Restaurants The Duchess & MR PORTER
- Rooftop W Lounge & WET deck
- 414 square meters of Events Space
- WIRED® Business Center
- Whatever/Whenever® service
- AWAY® Spa (2016)
- FIT® Gym (2016)
- X BANK Creative Incubator Space (2016)



# FLOOR PLAN MULTI FUNCTION ROOM

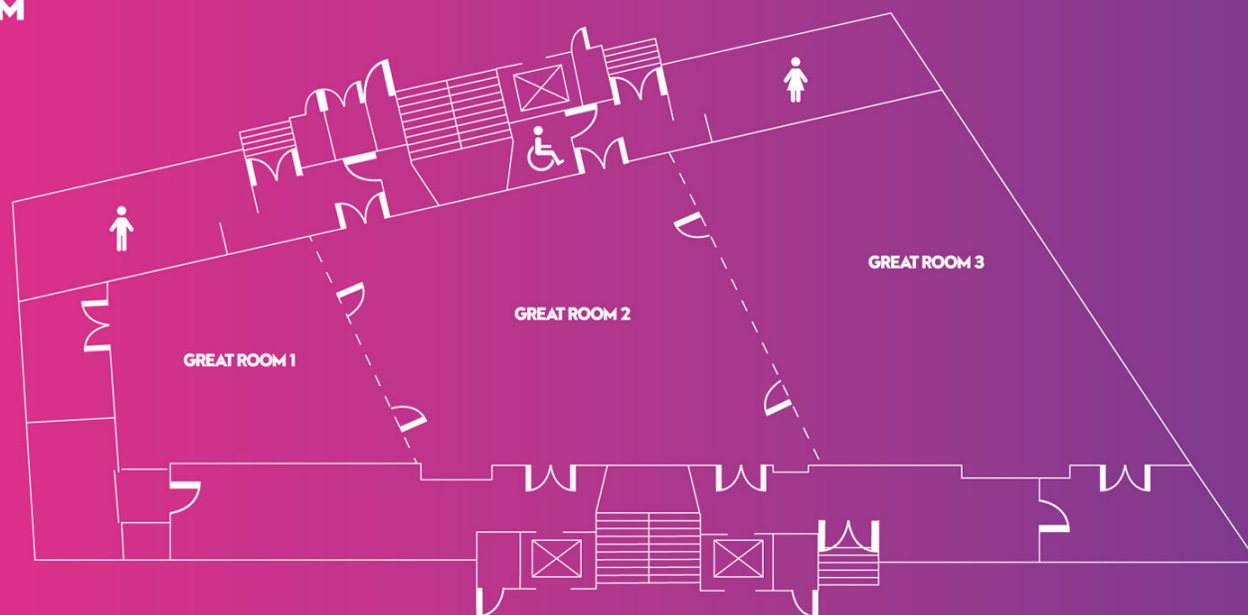

Room Name	Dim. (l x w) meters	Area sqm./sqf.	Height meters	Banq.	Thtr.	Board.	Class.	U-Shape	Cabaret	Cocktail
<b>Great Room 1</b>	6.89-9.55 x 8.04-11.37	76.7/251.4	2.95	40	40	20	27	18	30	50
<b>Great Room 2*</b>	9.55-13.10 x 14.35-15.53	166.4/545.1	4	64	100	30	48	30	48	100
<b>Great Room 3</b>	13.10-17.01 x 10.68-14.14	170.7/560	2.95	80	120	40	66	37	60	120
<b>Great Room 1+2+3</b>	6.89-17.01 x 32.85-41.04	413.8/1357.8	4	240	300	-	141	-	180	350
<b>Great Room 1+2</b>				120	150	-	75	-	90	180
<b>Great Room 2+3</b>				160	230	-	114	-	120	220

\*Great Room 2 can only be booked in combination with Great Room 1 and/or Great Room 3.



## HOTEL ADDRESS

Spuistraat 175  
1012 VN Amsterdam  
The Netherlands

## FOR ROOM RESERVATIONS

[reservations.wamsterdam@whotels.com](mailto:reservations.wamsterdam@whotels.com)

## FOR GROUPS & EVENTS

[events.wamsterdam@whotels.com](mailto:events.wamsterdam@whotels.com)

## EXPLORE

[wamsterdam.com](http://wamsterdam.com)  
[@wamsterdamhotel](https://www.instagram.com/wamsterdamhotel)  
[#WXXX](https://twitter.com/wamsterdamhotel)

spg\*  
Starwood  
Preferred  
Guest

Sheraton

WESTIN

ST REGIS

THE LUXURY  
COLLECTION

W  
HOTELS

L MERIDIEN

TRIBUTE  
PORTFOLIO

element

aloft

FOUR  
POINTS